

iCONIC GRANDE DATE

Setting the clock

1. Open the protection's arm:
Grab the arm protection in the 4 o'clock area and pull outward. The best way is to pinch the protection arm between thumb and forefinger.



2. Unscrew the crown.



3. Push the crown in setting position.



4. Set the clock:
Crown position I Normal function
Crown position II Date setting
 An extreme acceleration in setting the date with quick mode can induce a false date indication
Crown position III Time setting
 In this position the watch is stopped. Use this mode to save energy when you don't use the watch (saving approx. 70%)
5. Pull the crown in position I.
6. Screw the crown.
7. Close the protection arm.



ROD
ORIGINAL
DESIGN
OF SWITZERLAND

ICONIC GRANDE DATE

Setting the date following a battery change::

Example: -Date / time on the watch: 28 / 10:10
-Present date / time: 21 / 10 :10

1. Pull out the crown to position II (the watch continues to run).
2. Turn the crown until yesterday's date appears 9
- 3.* Pull out the crown to position III (the watch stops).
4. Turn the crown until the correct date (21) appears
- 5.**Continue to turn the crown until the correct time (10 :10AM)
6. Push the crown into position I.

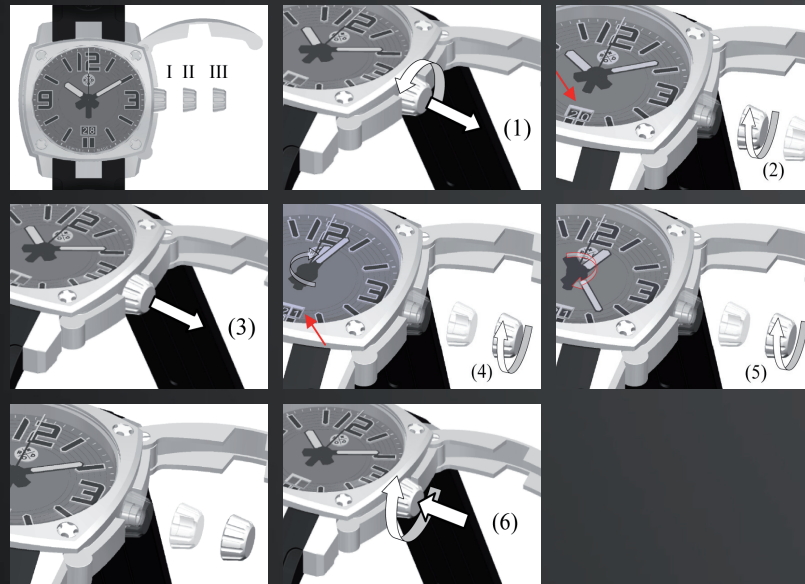

Changing the battery

To change the battery a special tooling is necessary.
This operation has to be made by a watch retailer service center,
otherwise seal can't be guaranteed.

Others:

In case your watch needs to be repaired or raise claims under guarantee,
please contact the point of sale.

Please note:

*) To set your watch to the exact second, please refer to the chapter
entitled "setting the clock".

***) Please observe the AM/PM clock rhythm.



ROD
ORIGINAL
DESIGN
OF SWITZERLAND